

ACCU-CHEK® TenderLink

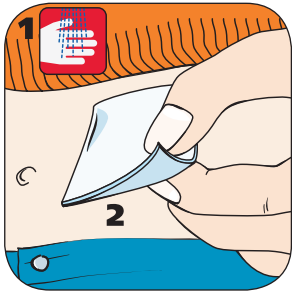

Picture 1
Choose a site away from the waistline, bones, scar tissue, belly button and recently used infusion sites.
1) Clean hands and 2) the site. Allow infusion site to dry before inserting the Accu-Chek TenderLink.

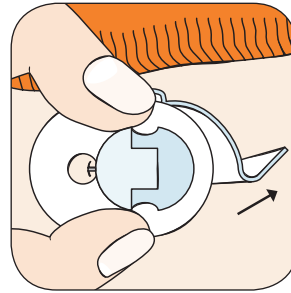

Picture 4
Remove the back side of the adhesive backing from the self-adhesive and press the self-adhesive firmly onto the skin.

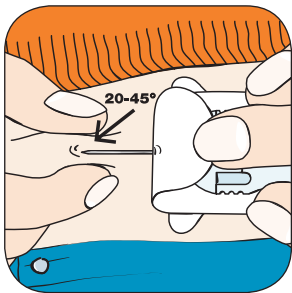

Picture 2
Remove the front half of the adhesive backing and the protective cover of the introducer needle. Pull back the edge of the self-adhesive with the index finger. Pinch together a bit of subcutaneous tissue at the disinfected site. Insert the introducer needle under the skin at an angle of 20-45°.

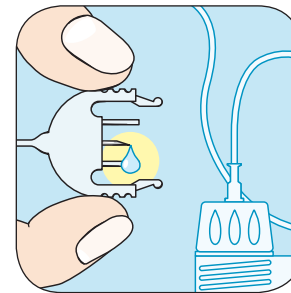

Picture 5
Screw the luer-lock firmly into the screw thread of the pump adapter. Fill the Accu-Chek TenderLink according to the pump manufacturer's operating instructions until the medication emerges at the tip of the connector needle. Do not leave air bubbles in either the cartridge or the transfer set.

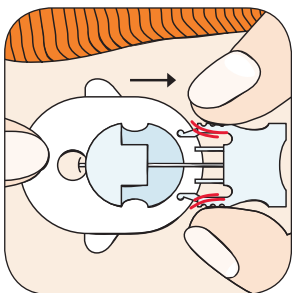

Picture 3
Press the self-adhesive firmly onto the skin in order to ensure secure placement of Accu-Chek TenderLink. Place one finger in front of the inspection window to fix it. Press the side clips of the introducer needle gently together and at the same time pull the introducer needle out of the skin.

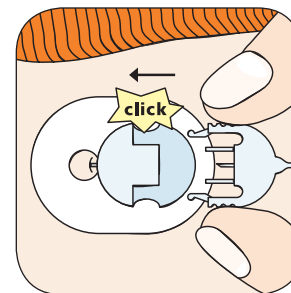

Picture 6
Connect the transfer set to the newly inserted head set with the bulging side upwards. A click must be heard when connecting. Fill the empty space of the cannula housing with a bolus of 0.7 units of insulin U-100 (7 µl). Start the pump.

Please refer to the Instructions for Use of the Accu-Chek TenderLink for detailed information.

ACCU-CHEK, LIVE LIFE. THE WAY YOU WANT. and ACCU-CHEK TENDERLINK are trademarks of Roche.
©2008 Roche Diagnostics



www.accu-check.com
Disetronic Medical Systems AG
3401 Burgdorf, Switzerland

ACCU-CHEK®

Live life. The way you want.

00048800042_V02/05.08