

# ACCU-CHEK® LinkAssist

## Handling Poster

### How to use the Accu-Chek LinkAssist insertion device to insert the Accu-Chek FlexLink infusion set

Please wash your hands before use. Choose a site away from waistline, bones, scar tissue, belly button and recent infusion sites. Prepare site according to the instructions from your health care professional. Allow the infusion site to dry before the soft cannula is inserted.



**1** Push the tensioning element (grey) of the insertion device into its base (blue).

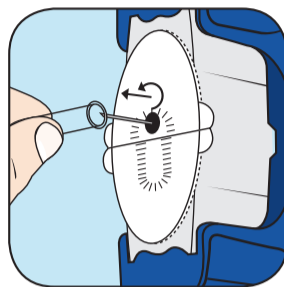

**2** The insertion device is now pretensioned. This step «locks» the safety catch in place, and automatically makes the insertion device secure.

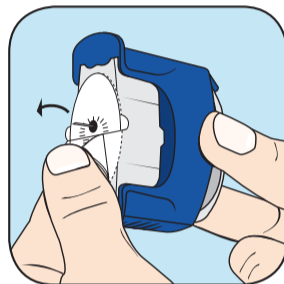

**3** Hold the infusion set by its protective cover and with the blue holder cap pointing upward, insert it from below into the opening of the insertion device until you feel it lock into place.

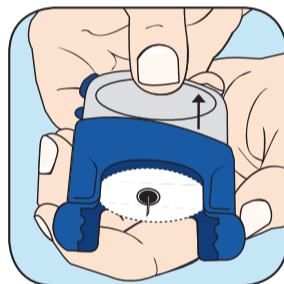

**4** Correct placement of the infusion set.  
**Note:** The elongated perforation mark on the self-adhesive backing directs you to the location of the tube connection.

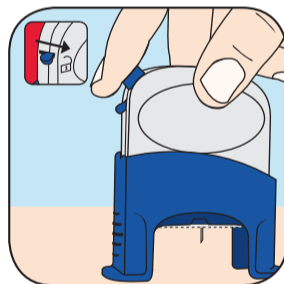

**5** Carefully remove the transparent protective cover of the infusion set by turning and pulling at the same time.

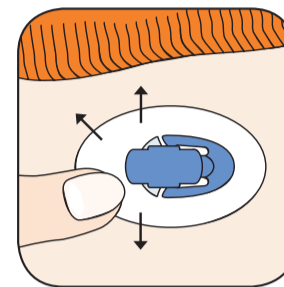

**6** Remove both pieces of the self-adhesive backing from the self-adhesive.

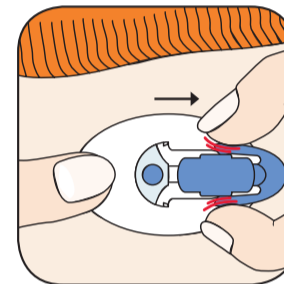

**7** Hold the base of the insertion device firmly in one hand and with the other hand pull the tensioning element out and up as far as it will go.

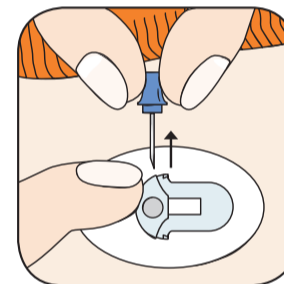

**8** Holding the tensioning element, position the insertion device onto the prepared infusion site. Slide the safety catch out of the «lock» position. Press the release button.

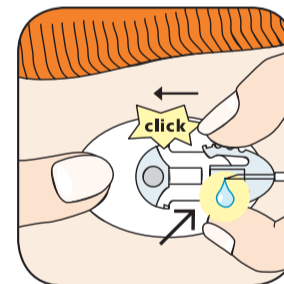

**9** Smooth out the self-adhesive and run your fingers over it. This ensures good skin contact.

**10** Hold the self-adhesive in place, gently press the side clips of the blue holder cap and pull it from the cannula housing.

**11** To remove the introducer needle, hold the cannula housing firmly to your body. Using its handle, withdraw the introducer needle in a straight angle.

**12** Connect the primed\* transfer set to the newly inserted head set. A click must be heard when connecting. Fill the empty space of the cannula housing with a bolus of 1.0 units of insulin U-100. Start distribution with the pump.

\* How to prime the transfer set: Screw the luer-lock tightly into the screw thread of the pump adapter. Fill the Accu-Chek FlexLink according to the pump manufacturer's operating instructions until the medication emerges at the tip of the connector needle. Do not leave air bubbles in either the cartridge or the transfer set.

Please refer to the Instructions for Use of both products for warnings and precautions and more detailed information.



ACCU-CHEK and LIVE LIFE. THE WAY YOU WANT. ACCU-CHEK FLEXLINK, ACCU-CHEK LINKASSIST are trademarks of Roche.  
© 2006 Roche Diagnostics

www.accu-chek.com  
Disetronic Medical Systems AG  
CH-3401 Burgdorf, Switzerland

**ACCU-CHEK®**

Live life. The way you want.